

Drop off and Pick Up LES 2020

Link to video: <https://www.youtube.com/watch?v=xnrMuCOYt8M>

Arrival:

- LES Doors open at 7:45
- School Starts at 8:10
- Kindergartners will be walked into school by school staff.
- 1st-4th grade students will be dropped off on the perimeter of school grounds, walk to their designated entrance and enter the school.
- Staff will greet students at the doors.
- Grab and Go breakfast will be available for students who eat breakfast at school.
- Students will sanitize their hands and walk to their classrooms.
- The playground is closed.
- The roundabout will be closed to cars.
- Please walk Kindergarten students to the roundabout.
- 1st and 3rd will enter through the main entrance.
- 2nd and 4th will enter through the west entrance.

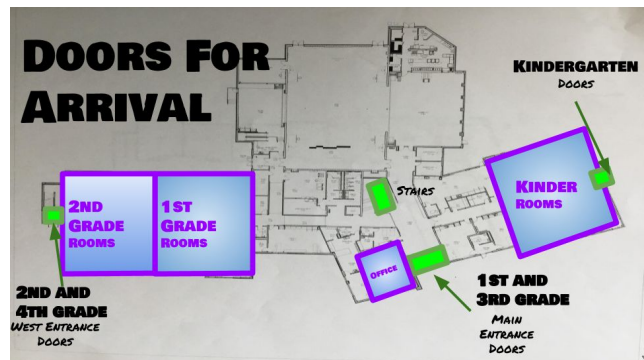

Departure:

- Please walk to your students designated pick up area.
- Signs will be posted where teachers will walk students out to.
- The playground is closed at pick up time.
- The roundabout is closed to cars.

